



- Large selection of different actuators
- Versions as an NC with positive opening, NO or disconnect terminal

WebCode **8082A**



R. STAHL Series 8082 contact elements have an NO contact and a positive opening operation NC contact, made from silver-nickel or gold-plated. They can be easily combined with contact blocks and enable customised installations, also due to the large selection of the various actuators.

## Technical Data

### Explosion Protection

Application range (zones)	1 2
IECEX gas certificate	IECEX PTB 06.0011U
IECEX gas explosion protection	Ex db eb IIC T6 Gb
IECEX firedamp certificate	IECEX PTB 06.0011U
IECEX firedamp protection	Ex db eb I Mb
ATEX gas certificate	PTB 00 ATEX 1031 U
ATEX gas explosion protection	Ex II 2 G Ex db eb IIC T6 Gb
ATEX firedamp certificate	PTB 00 ATEX 1031 U
ATEX firedamp protection	Ex I M2 Ex db eb I Mb
ATEX firedamp protection 2	Ex I M2 I Mb
UL gas certificate	E182378V1S1
Inmetro gas certificate	ULBR130645U
Certificates	ATEX (PTB), Brazil (ULB), Canada / USA (UL), China (CQST), EAC (ENDCE), IECEX (PTB), Korea (KTL), SIL (exida)
Notes	Product label may vary. Series devices have certification according to ATEX, IECEX, NEC and CEC.

### Functional Safety

SIL-capable	without actuator or with actuators 8602/3-006, 8602/3-009, 8602/3-010, 8602/3-012
-------------	---

### Electrical Data

Max. rated operational voltage	550 V
Min. rated operational voltage	24 V
Rated operational current	150 mA / 10 A
UL rated operational current	600 A
Electrical service life	10 <sup>6</sup> operating cycles
Mechanical service life	10 <sup>6</sup> operating cycles

# Control Devices

Contact element For mounting rail mounting

Ex e

8082/1-1-00 Art. No. 132636



## Electrical Data

Switching capacity AC-12	250 V/10 A 400 V/7.5 A 550 V/5 A
Switching capacity AC-15	110 V/10 A 250 V/6 A 400 V/4 A
Switching capacity DC-13	60 V/6 A
Switching capacity DC-13 2 contact elements in series	230 V/1 A 110 V/2.5 A

## Ambient Conditions

Ambient temperature	-60 °C ... +70 °C (T6)
Operating temperature	-60 °C ... +100 °C

## Mechanical Data

IP degree of protection (IEC 60529)	IP20
Enclosure material	Polyamide
Contact material	Silver-nickel
Silicone-free	Yes
Max. connection cross-section, finely stranded	2.5 mm <sup>2</sup>
Solid connection cross section	0.75 – 2.5 mm <sup>2</sup>
Finely stranded connection cross section	0.75 – 2.5 mm <sup>2</sup>
Connection cross-section, finely stranded with core end sleeve	0.75 – 2.5 mm <sup>2</sup>
Number of NCs	1
Positive opening operation	Yes
Contacts	1 NC
Packaging unit	1
Weight	0.025 kg
Weight	0.055 lb

## Mounting / Installation

Tightening torque	1.2 Nm
Tightening torque lbf in	10.62 lbf in
Connection type	Screw terminal
Max. USA solid connection terminals	14 AWG

## Dimensional Drawings (All Dimensions in mm [inches]) – Subject to Alterations

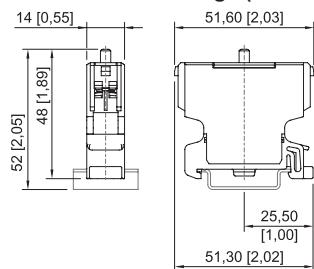

Contact element, single

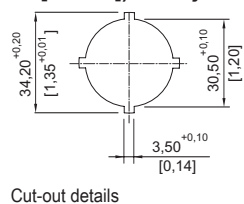

Cut-out details

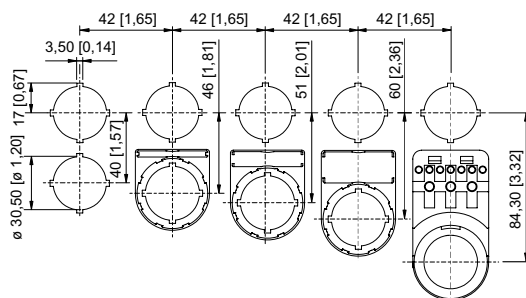

Cut-out with / without front label

## Accessories

# Control Devices

Contact element For mounting rail mounting

Ex e

8082/1-1-00 Art. No. 132636



Pushbutton		Art. No.
	Ø 39 mm Black Designation plate: Black, blank disc without text Silicone-free: Yes	223691
	Ø 39 mm Black Designation plate: Black, blank disc without text Silicone-free: No	223692
Mushroom pushbutton, black		Art. No.
	Ø 39 mm Black Designation plate: Black, blank disc without text Silicone-free: Yes	244563
	Ø 39 mm Black Designation plate: Black, blank disc without text Silicone-free: No	244564
Mushroom pushbutton, red		Art. No.
	Ø 39 mm Red/black Designation plate: Red, blank disc without text Silicone-free: Yes	244565
	Ø 39 mm Red/black Designation plate: Red, blank disc without text Silicone-free: No	244566
Mushroom stay-put button with key		Art. No.
	Ø 39 mm Red/black Closing: MS1 Silicone-free: Yes	223695
	Ø 39 mm Red/black Closing: MS1 Silicone-free: No	223696
Key-operated switch actuator		Art. No.
	Ø 39 mm Black Closing: MS1 Number of switching positions: 2 Switching function: Latching / Latching Silicone-free: No	244574
	Ø 39 mm Black Closing: MS1 Number of switching positions: 3 Switching function: Latching / Latching / Latching Silicone-free: No	244633

## Control Devices

Contact element For mounting rail mounting

Ex e

8082/1-1-00 Art. No. 132636

STAHL

### Mushroom stay-put button with EM-STOP key

Art. No.

	Ø 39 mm Yellow/red Designation plate: With yellow backing plate Closing: MS1 Silicone-free: Yes	223693
	Ø 39 mm Yellow/red Designation plate: With yellow backing plate Closing: MS1 Silicone-free: No	223694

### Mushroom stay-put button EM-STOP

Art. No.

	Ø 39 mm Yellow/red Designation plate: With yellow backing plate Silicone-free: Yes	223697
	Ø 39 mm Yellow/red Designation plate: With yellow backing plate Silicone-free: No	223698

### Mushroom stay-put button, black

Art. No.

	Ø 39 mm Black Silicone-free: Yes	223699
	Ø 39 mm Black Silicone-free: No	223700

### Mushroom pushbutton 55 mm red

Art. No.

	Ø 55 mm Black/red Designation plate: Red, blank disc without text Silicone-free: Yes	244634
	Ø 55 mm Black/red Designation plate: Red, blank disc without text Silicone-free: No	244635

### Mushroom stay-put button 55 mm EM-STOP

Art. No.

	Ø 55 mm Yellow/red Designation plate: With yellow backing plate Silicone-free: Yes	244636
	Ø 55 mm Yellow/red Designation plate: With yellow backing plate Silicone-free: No	244637

## Control Devices

Contact element For mounting rail mounting

Ex e

8082/1-1-00 Art. No. 132636



### Twin pushbutton

Art. No.

	Black Silicone-free: Yes	244638
	Black Silicone-free: No	244639



### Mushroom pushbutton 55 mm black

Art. No.

	Ø 55 mm Black Designation plate: Black, blank disc without text Silicone-free: Yes	244642
	Ø 55 mm Black Designation plate: Black, blank disc without text Silicone-free: No	244643

### Small rotary actuator, not lockable

Art. No.

	Ø 39 mm Black Designation plate: 0/OFF – I/ON Number of switching positions: 2 Lockable in: Not padlockable Switching function: Latching / Latching Silicone-free: Yes	244646
	Ø 39 mm Black Designation plate: 0/OFF – I/ON Number of switching positions: 2 Lockable in: Not padlockable Switching function: Latching / Latching Silicone-free: No	244647
	Ø 39 mm Black Designation plate: I – 0 – II Number of switching positions: 3 Lockable in: Not padlockable Switching function: Latching / Latching / Latching Silicone-free: Yes	244648
	Ø 39 mm Black Designation plate: I – 0 – II Number of switching positions: 3 Lockable in: Not padlockable Switching function: Latching / Latching / Latching Silicone-free: No	244649

## Control Devices

Contact element For mounting rail mounting

Ex e

8082/1-1-00 Art. No. 132636



### Small rotary actuator, lockable

		Art. No.
	Ø 39 mm Black Designation plate: 0/OFF – I/ON Number of switching positions: 2 Lockable in: One pos. with one lock Switching function: Latching / Latching Silicone-free: Yes	244650
	Ø 39 mm Black Designation plate: 0/OFF – I/ON Number of switching positions: 2 Lockable in: One pos. with one lock Switching function: Latching / Latching Silicone-free: No	244651
	Ø 39 mm Black Designation plate: I – 0 – II Number of switching positions: 3 Lockable in: One pos. with one lock Switching function: Latching / Latching / Latching Silicone-free: Yes	244652
	Ø 39 mm Black Designation plate: I – 0 – II Number of switching positions: 3 Lockable in: One pos. with one lock Switching function: Latching / Latching / Latching Silicone-free: No	244653

### Illuminated pushbutton (spring return)

		Art. No.
	Diameter 39.0 mm All colours Silicone-free: Yes	244654
	Diameter 39.0 mm All colours Silicone-free: No	244655

## Spare Parts

### Mushroom stay-put button with key

Art. No.

## Control Devices

Contact element For mounting rail mounting

Ex e

8082/1-1-00 Art. No. 132636



	Ø 39 mm Red/black Closing: MS2 Silicone-free: Yes	270409
	Ø 39 mm Red/black Closing: MS2 Silicone-free: No	270412
	Ø 39 mm Red/black Closing: MS3 Silicone-free: Yes	270410
	Ø 39 mm Red/black Closing: MS3 Silicone-free: No	270413
	Ø 39 mm Red/black Closing: MS4 Silicone-free: Yes	270411
		<b>Art. No.</b>
	Ø 39 mm Red/black Closing: MS4 Silicone-free: No	270414

## Control Devices

Contact element For mounting rail mounting

Ex e

8082/1-1-00 Art. No. 132636



### Key-operated switch actuator

Art. No.



Ø 39 mm Black Closing: MS1 Number of switching positions: 2 Switching function: Latching / Latching Silicone-free: Yes	244573
Ø 39 mm Black Closing: MS2 Number of switching positions: 2 Switching function: Latching / Latching Silicone-free: Yes	272935
Ø 39 mm Black Closing: MS2 Number of switching positions: 2 Switching function: Latching / Latching Silicone-free: No	270418
Ø 39 mm Black Closing: MS3 Number of switching positions: 2 Switching function: Latching / Latching Silicone-free: Yes	274089
Ø 39 mm Black Closing: MS3 Number of switching positions: 2 Switching function: Latching / Latching Silicone-free: No	270419
Ø 39 mm Black Closing: MS4 Number of switching positions: 2 Switching function: Latching / Latching Silicone-free: Yes	272936
Ø 39 mm Black Closing: MS4 Number of switching positions: 2 Switching function: Latching / Latching Silicone-free: No	270420



## Control Devices

### Contact element For mounting rail mounting

Ex e

8082/1-1-00 Art. No. 132636



	Ø 39 mm Black Closing: MS1 Number of switching positions: 3 Switching function: Latching / Latching / Latching Silicone-free: Yes	244632
	Ø 39 mm Black Closing: MS2 Number of switching positions: 3 Switching function: Latching / Latching / Latching Silicone-free: Yes	274090
	Ø 39 mm Black Closing: MS2 Number of switching positions: 3 Switching function: Latching / Latching / Latching Silicone-free: No	270421
	Ø 39 mm Black Closing: MS3 Number of switching positions: 3 Switching function: Latching / Latching / Latching Silicone-free: Yes	274091
	Ø 39 mm Black Closing: MS3 Number of switching positions: 3 Switching function: Latching / Latching / Latching Silicone-free No	270422
	Ø 39 mm Black Closing: MS4 Number of switching positions: 3 Switching function: Latching / Latching / Latching Silicone-free: Yes	274092
	Ø 39 mm Black Closing: MS4 Number of switching positions: 3 Switching function: Latching / Latching / Latching Silicone-free: No	270423

## Control Devices

Contact element For mounting rail mounting

Ex e

8082/1-1-00 Art. No. 132636



### Mushroom stay-put button with EM-STOP key

Art. No.

	Ø 39 mm Yellow/red Designation plate: With yellow backing plate Closing: MS2 Silicone-free: Yes	274099
	Ø 39 mm Yellow/red Designation plate: With yellow backing plate Closing: MS2 Silicone-free: No	270415
	Ø 39 mm Yellow/red Designation plate: With yellow backing plate Closing: MS3 Silicone-free: Yes	274100

Art. No.

	Ø 39 mm Yellow/red Designation plate: With yellow backing plate Closing: MS3 Silicone-free: No	270416
---	--	--------

### Mushroom stay-put button with EM-STOP key

Art. No.

	Ø 39 mm Yellow/red Designation plate: With yellow backing plate Closing: MS4 Silicone-free: Yes	274101
	Ø 39 mm Yellow/red Designation plate: With yellow backing plate Closing: MS4 Silicone-free: No	270417

We reserve the right to make alterations to the technical data, dimensions, weights, designs and products available without notice. The illustrations cannot be considered binding.