

General Specifications

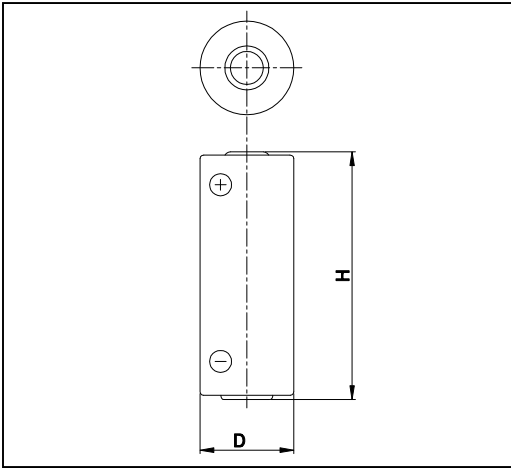

Nominal Voltage (V)		3
Nominal Capacity (mAh) *1		3000
Standard Discharge Current (mA)		0.5
Operating Temperature Range (°C) *2		-40 ~ +85
Max. Dimensions (mm)	Diameter (D)	17.0
	Height (H)	45.0
Approx. Weight (g)		23

*1 Nominal capacity is determined at an end voltage of 2.0V when the battery is allowed to discharge at a standard current level at +23°C.

*2 Consult FDK when using batteries at temperatures exceeding the -20°C to +60°C range.

Note) Battery Handling Precautions

English) http://www.fdk.com/battery/lithium_e/caution/

Japanese) <http://www.fdk.co.jp/battery/lithium/caution/>

Typical Characteristics (Estimated Curve)

Temperature Characteristics of CR8·LHC

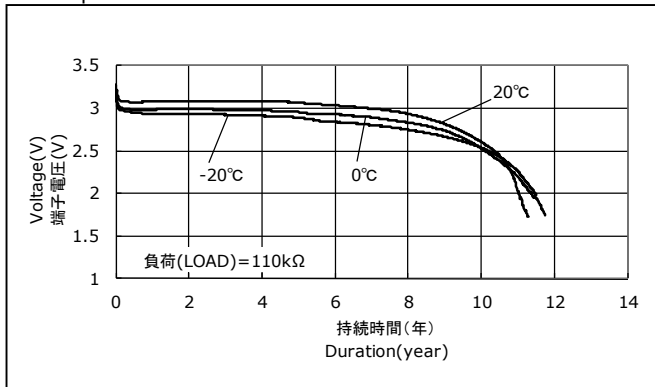

Temperature Characteristics of CR8·LHC

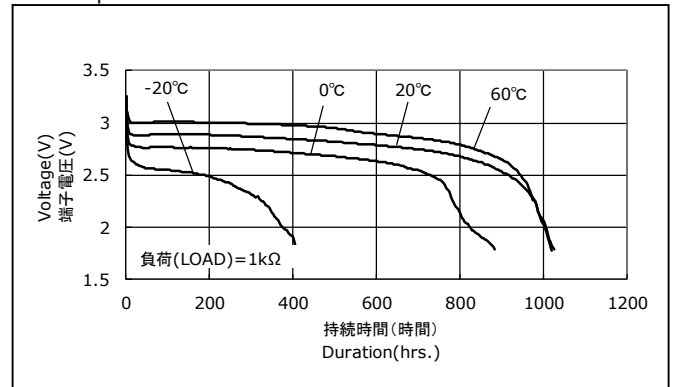

Pulse discharge Characteristics of CR8·LHC

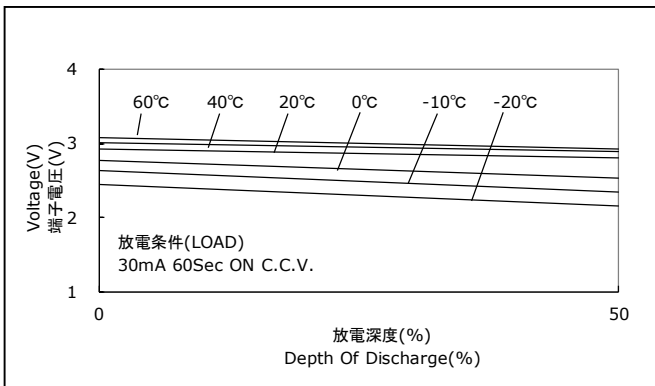

Discharge Load vs. Cell Capacity of CR8·LHC

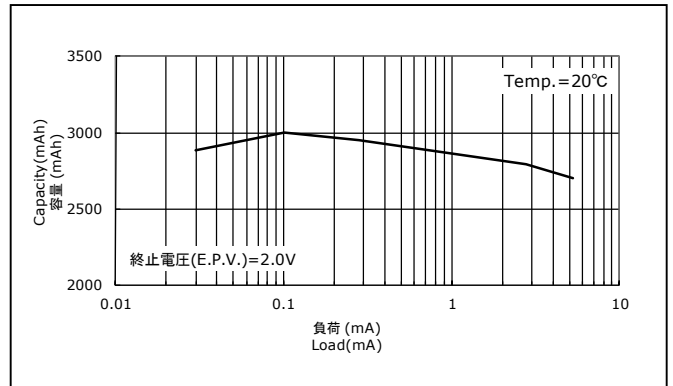

The data in this document are for descriptive purposes only and are not intended to make or imply any guarantee or warranty.